

WHAT IS PEBBLEPAD?

PebblePad is a personal learning space that can be used to create e-portfolio's. By providing a space where learners can collect evidence of and reflection on their learning, PebblePad can be used in many different ways to support learning, teaching and assessment.

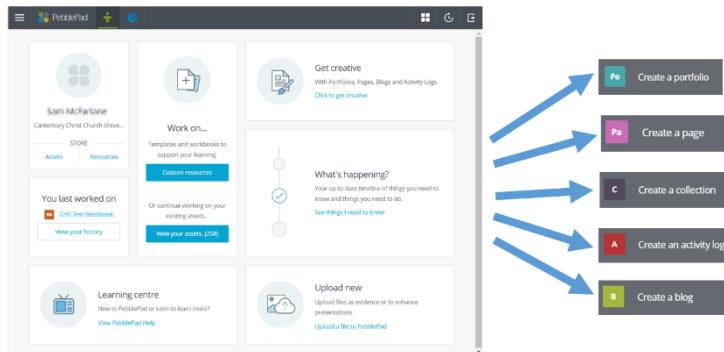

WHAT CAN PEBBLEPAD BE USED FOR?

PebblePad can be used by anyone who wants to record, reflect on and learn from experience:

- Planning personal and professional development – PebblePad supports personal learning as an individual can collect pieces of evidence in a secure online environment which can be repurposed for and shared with different audiences.
- Preparing for accreditation – Many professional bodies require evidence of competencies and PebblePad can provide the tool to evidence this learning.
- Developing evidence for employability – PebblePad can be used to build and maintain dynamic CVs.
- Promoting reflective learning – Templates are available (and can be developed) to prompt students to reflect on their learning and create action plans.
- Assessment – students can share their work with their tutor for formative comments but can also submit their work for summative assessment.
- Peer Review and collaboration– students can work collaboratively through PebblePad.

FURTHER INFORMATION FROM THE SECTOR

JISC. (2014). *e-Portfolio infoKit*. Available at: <http://www.jiscinfonet.ac.uk/infokits/e-portfolios/> [Accessed 13 July 2015].

JISC. (2008). *Effective practice with e-Portfolios: Supporting 21st century learning*. Bristol, England: HEFCE. Available

at: <http://webarchive.nationalarchives.gov.uk/20140702233839/http://www.jisc.ac.uk/publications/programmerelated/2008/effectivepracticeportfolios.aspx> [Accessed 13 July 2015].

PebblePad. (2013). *PebblePad Examples*. Available

at: <http://archive.pebblepad.co.uk/pebblepad.examples.asp> [Accessed 13 July 2015].

Sutherland, S., Brophy, J. and Chesney, S. (2011). *Pebblegogy: Ideas and activities to inspire and engage learners*. Available at <http://archive.pebblepad.co.uk/pebblegogy.book.asp> [Accessed 13 July 2015].

WHAT DO I NEED TO ACCESS PEBBLEPAD?

PebblePad is accessible to staff and students from the Pebblepad tab on the homepage in Blackboard.

For all users there is information on how Pebblepad can be used in the Blackboard Help area and in the Learning Centre within Pebblepad.